

Lone Star Leadership Academy

Austin/San Antonio

Student Drop-Off on Sunday

Location: Education in Action
16000 Ranch Road 12
Wimberley, TX 78676

When you arrive:

- Bring your luggage inside.
- Dinner will be provided for student participants.

Time: 5:00 PM

Contact Information

Education in Action Emergency Cell Phone: 817-793-8300*

**If you have any questions on Sunday, call the emergency cell phone number to speak with the camp director. If you cannot reach the director, call the office cell phone below to speak with Ashley Barnes.*

Education in Action Office Cell Phone: 817-714-2134

Transportation Changes

Requests to add the charter bus or airport shuttle transportation options must be made **in writing** and no later than **two Fridays (nine calendar days) prior to the camp start date**. The fee for either transportation option is \$70.00, payable by credit or debit card only. Requests will be honored on a space-available basis.

Driving Directions*

**Education in Action recommends that you plan your route prior to departing for drop-off.*

From Dallas

Take IH-35 S. Take exit #230 and merge onto US-290 W in Austin. After about 20 miles, turn left onto Ranch Road 12 and continue for 12.6 miles. The last major intersection will be Winter's Mill Pkwy. Education in Action is about ½ mile further on the left, directly across from a white water tower. The front of the building resembles a house with a small porch. If you reach downtown Wimberley, you have gone about 3 miles too far.

From Houston

Take I-10 west toward San Antonio. Take exit #632 and merge onto US-183 N. In Luling, turn right onto S Magnolia Ave. and then take the 3rd left onto TX-80 N/E Austin St. After passing I-35, turn right onto Moore St./Ranch Road 12 and continue for about 16 miles. Education in Action is about 3 miles past downtown Wimberley on the right, directly across from a white water tower. The front of the building resembles a house with a small porch. If you reach Winter's Mill Pkwy., you have gone about ½ mile too far.

From West Texas

Take Highway 71 east towards Austin. Turn right on FM 3238/Hamilton Pool Rd. and continue for 6.7 miles. Turn left onto Brooks Ranch Road/Ranch Road 12 and continue for 20 miles. The last major intersection will be Winter's Mill Pkwy. Education in Action is about ½ mile further on the left, directly across from a white water tower. The front of the building resembles a house with a small porch. If you reach downtown Wimberley, you have gone about 3 miles too far.

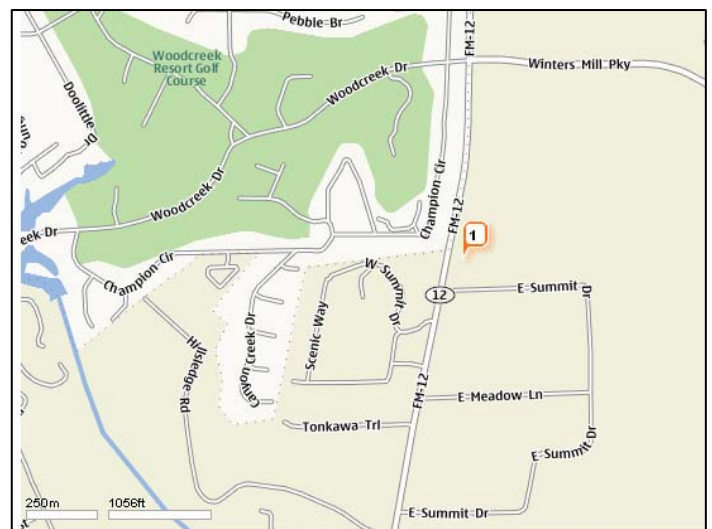
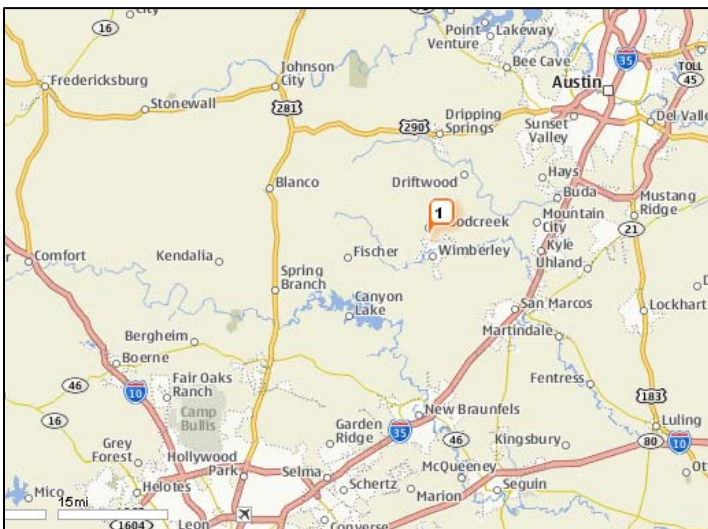

Lone Star Leadership Academy Austin/San Antonio

Student Pick-Up on Friday

Location: Parking Lot across from the Stephen F. Austin State Office Building
1700 Congress Ave.
Austin, TX 78701



Time: 1:00 PM

When you arrive: You will meet your student at the charter bus, which will be parked alongside a state parking lot (marked "A" on the map) on the N.E. corner of Congress and 18th Street. You may park in this lot temporarily to pick up your student, but you may not leave your vehicle there.

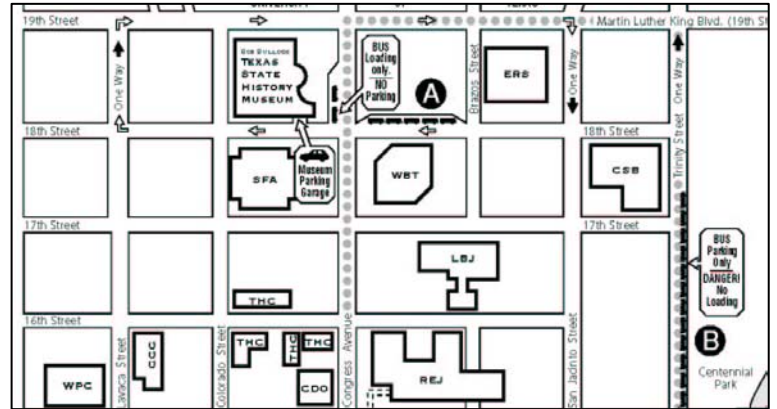

Driving Directions*

*Education in Action recommends that you plan your route prior to departing for pick-up.

From Dallas

Take I-35E S toward Waco. Merge onto I-35 S/US-81 S via the left exit. Once you enter Austin, take the exit toward MLK Blvd./ 15th Street. Turn right onto E. Martin Luther King Jr. Blvd. Turn left onto Congress Avenue.

From Houston

Take I-10 west to Columbus and exit onto Highway 71 traveling west towards La Grange/Austin. Merge onto I-35 N/US-81 N. Once you enter Austin, take the exit toward 15th Street/MLK Blvd./State Capitol. Turn left on E. 15th Street. Turn right on Congress Avenue.

From West Texas

Take I-20 E. Merge onto US-83 S/US-84 E toward Ballinger/Coleman/San Angelo. Merge onto US-183 S. Merge onto I-35 S/US-81 S. Once you enter Austin, take the exit toward MLK Blvd./ 15th Street. Turn right onto E. Martin Luther King Jr. Blvd. Turn left onto Congress Avenue.

